



SERVICE ENTRANCE

Copper wire only
600V

WISE GRIP CONNECTOR

Use as splice or tap
 For grounding to flat bar with one or two conductors
 Lay-in (side-entry) for easy installation
 V-groove aligns conductors
 Heavy construction for excellent heat dissipation
 Interlock design for resistance to vibration
 High-strength silicon bronze body with stainless-steel hex head bolt

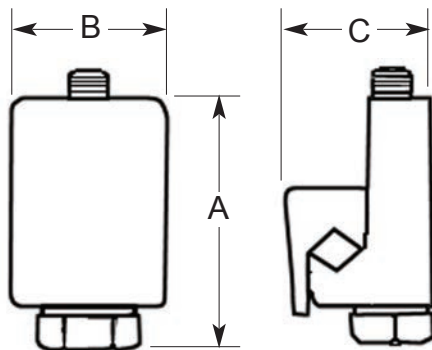

GVC SERIES

NAED NUMBER	CATALOG NUMBER	CONDUCTOR RANGE		DIMENSIONS APPROX (IN)			BOLT		CTN QTY	EST. SHIPPING	
		MAX 2 WIRE	MIN 1 WIRE	A	B	C	SIZE (IN)	HEAD		WEIGHT (lbs)	UNIT
15506	GVC6	6SOL-8STR	6SOL-8STR	7/8	5/8	3/4	1/4	3/8 SLOTTED	30	2.0	CTN
15504	GVC4	4STR	4SOL	1 1/8	3/4	13/16	15/16	9/16	25	3.1	CTN
15503	GVC3	3STR - 2SOL	2SOL	1 3/8	13/16	15/16	15/16	9/16	20	4.3	CTN
15502	GVC2	2STR	2SOL	1 3/8	13/16	15/16	15/16	9/16	15	3.2	CTN
15510	GVC10	1/0STR	2STR	1 5/8	13/16	1	15/16	9/16	10	2.1	CTN
15520	GVC20	2/0STR-3/0SOL	2/0STR	2	7/8	1 1/4	3/8	9/16	10	3.6	CTN
15540	GVC40	4/0STR	4/0SOL	2 1/8	1	1 3/8	3/8	9/16	6	2.7	CTN
15535	GVC350	350 KCMIL	350 KCMIL	3	1 1/4	1 3/4	1/2	3/4	5	2.8	CTN

Available with shear-head bolt to assure proper torque and tamper-proof installation; add "-TA" to Cat. No. and contact factory for availability.
 Available tin-plated; add "-P" to Catalog No. and contact factory for availability.