



## GROUNDING

### U-BOLT GROUND CLAMP CONNECTORS

Heavy Duty – Bronze castings for strength and ruggedness

Use to connect wire to pipe or fence posts

High copper alloy bronze castings with silicon bronze hardware

Suitable for direct burial in earth or concrete

**Direct Burial**

Continuous Loop  
Copper wire only

### CZ SERIES

### Three-Wire Parallel

NAED NUMBER	CATALOG NUMBER	ROD SIZE (IN)	WATER PIPE SIZE (IPS)	CABLE RANGE	EST. SHIPPING	
					WEIGHT (lbs)	UNIT
24904	<b>CZ 104</b>	5/8 or 3/4	3/8	#4 - 2/0	.93	EA
24905	<b>CZ 105</b>			2/0 - 250	1.2	EA
24908	<b>CZ 108</b>	7/8 or 1	1/2 or 3/4	#4 - 2/0	1.3	EA
24909	<b>CZ 109</b>			2/0 - 250	2.1	EA
24910	<b>CZ 110</b>			300 - 500	1.8	EA
24914	<b>CZ 114</b>			#4 - 2/0	1.3	EA
24915	<b>CZ 115</b>	-	1	2/0 - 250	1.3	EA
24916	<b>CZ 116</b>			300 - 500	3.2	EA
24920	<b>CZ 120</b>			#4 - 2/0	1.5	EA
24921	<b>CZ 121</b>	-	1 1/4	2/0 - 250	1.6	EA
24922	<b>CZ 122</b>			300 - 500	3.7	EA
24926	<b>CZ 126</b>			#4 - 2/0	1.5	EA
24927	<b>CZ 127</b>	-	1 1/2	2/0 - 250	1.83	EA
24928	<b>CZ 128</b>			300 - 500	3.7	EA
24932	<b>CZ 132</b>			#4 - 2/0	1.9	EA
24933	<b>CZ 133</b>	-	2	2/0 - 250	2.6	EA
24934	<b>CZ 134</b>			300 - 500	4.3	EA
24937	<b>CZ 137</b>			#4 - 2/0	2.3	EA
24938	<b>CZ 138</b>	-	2 1/2	2/0 - 250	3.2	EA
24939	<b>CZ 139</b>			300 - 500	4.7	EA
24942	<b>CZ 142</b>			#4 - 2/0	2.7	EA
24943	<b>CZ 143</b>	-	3	2/0 - 250	3.5	EA
24944	<b>CZ 144</b>			300 - 500	5.4	EA
24947	<b>CZ 147</b>	-	3 1/2	#4 - 2/0	3.0	EA

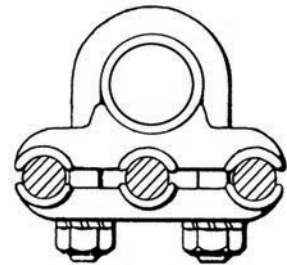

Connects three cables parallel to rod or pipe

### RAISED-FLOOR PEDESTAL CLAMPS

Pedestal clamp for raised computer-floor grounding grid applications

Use for signal reference grid, static ground drain, fault current ground

Accommodates one or two grounding wires

Install on round or square pedestal, as noted

Bronze high-copper alloy body and silicon bronze hardware

Suitable for direct burial in earth or concrete

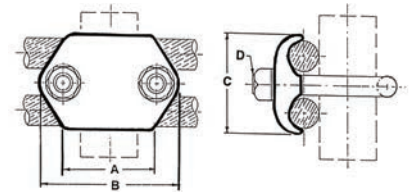

Connects one or two cables perpendicular to pedestal

### CR SERIES

T = Throat of U-bolt

NAED NUMBER	CATALOG NUMBER	PEDESTAL		CONDUCTORS		DIMENSIONS					CTN QTY	EST. SHIPPING	
		SIZE (IN)	TYPE	NO.	SIZE	A	B	C	D	T		WEIGHT (lbs)	UNIT
25807	<b>CR107</b>	3/4 - 1 3/4 - 7/8	ROUND SQUARE	1 or 2	#8-4 STR	1.50	2.38	1.3	3/8	1.15	20	7.8	CTN
25808	<b>CR108</b>	3/4 - 1 3/4 - 7/8	ROUND SQUARE	1 or 2	#4-2/0 STR	1.50	2.38	1.7	3/8	1.15	20	9.7	CTN
25814	<b>CR114</b>	1 1/4	ROUND	1 or 2	#4-2/0 STR	1.75	2.62	1.7	3/8	1.38	20	9.8	CTN

