



## GROUNDING

### GROUND ROD CLAMPS

Silicon bronze body  
Bronze or stainless steel bolt

### G SERIES

NAED NUMBER	CATALOG NUMBER	GROUND ROD SIZE (IN)	GROUND WIRE MAX	CTN QTY	EST. SHIPPING	
					WEIGHT (lbs)	UNIT
<b>HEAVY DUTY</b>						
27000	G 29	3/8	#4 STR	50	3.2	CTN
27010	G 30	1/2	#4 SOL	50	4.2	CTN
27020	G 31	5/8	1/0 SOL	50	6.1	CTN
27030	G 32	3/4	#2 SOL	50	8.0	CTN
<b>* HEAVY DUTY</b>						
27050	G 120	1/2	#2 STR	50	7.7	CTN
27090	G 580	5/8	1/0 STR	50	8.5	CTN
27070	G 340	3/4	1/0 STR	50	10.4	CTN
27040	G 100	1	4/0 STR	25	6.0	CTN
<b>ECONOMY CLAMP</b>						
27015	G 31E	5/8	#2 STR	50	4.9	CTN

PLATING: For tin plating add suffix letter "P" to catalog numbers.  
\* For allen set screws add suffix "A" to catalog number.

### Tork-Away™ CLAMP

Torque-off bolt head to assure torque and tamper resistance **Brass Bolt**

NAED NUMBER	CATALOG NUMBER	GROUND ROD SIZE (IN)	GROUND WIRE MAX	CTN QTY	EST. SHIPPING	
					WEIGHT (lbs)	UNIT
26910	*G5810B	5/8	1/0 - #8 AWG	10	1.4	CTN

\* G5810B not UL listed.

### UNIVERSAL LARGE-WIRE

Extra heavy duty bronze body  
Stainless steel bolts  
More than 1½ inches of contact with 2-bolt clamp

NAED NUMBER	CATALOG NUMBER	GROUND ROD SIZE (IN)	GROUND WIRE RANGE	CTN QTY	EST. SHIPPING	
					WEIGHT (lbs)	UNIT
26923	*G3435	1/2	#6 SOL - 350 MCM	5	5	CTN
		5/8	#6 SOL - 350 MCM			
		3/4	#2 SOL - 250 MCM			
26924	*G3410	**3/8 - 3/4	#8 SOL - 1/0 AWG	10	2	CTN

\* Fits all size ground rods indicated.

\*\* Not UL for 3/8 rod.

### LARGE TWO-WIRE

Bronze body, stainless steel U-bolt  
More than 1½ inches of contact area  
Fits all ground rod sizes up through 1 inch diameter

NAED NUMBER	CATALOG NUMBER	GROUND ROD SIZE (IN)	WIRE RANGE	CTN QTY	EST. SHIPPING	
					WEIGHT (lbs)	UNIT
26930	G1500	1/2 - 1	#6 - 250MCM 2 WIRES PERPENDICULAR TO ROD #6 - 500MCM 1 WIRE PARALLEL TO ROD	5	2	CTN

Also available with Tork-Away™ Security Hardware to assure required torque and provide tamper resistance. Add "TA" to catalog number and contact factory for availability and price.

**Direct Burial**  
Copper wire only

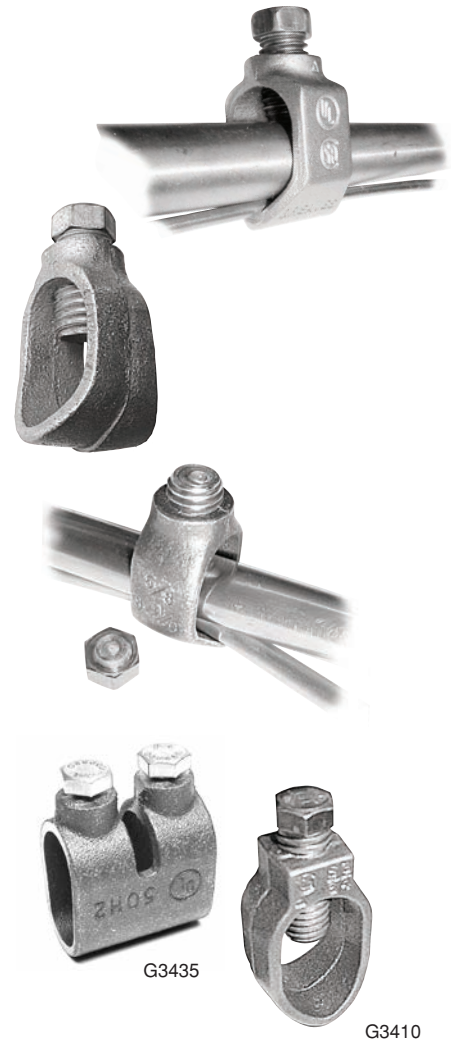

**Continuous Loop**





## POOL and SPA

# “Jones Bond™” system

**Direct Burial**

Copper wire only

## GROUND ROD CLAMPS

For connecting ground wire to ground rod  
Cast bronze body with silicon bronze bolt  
UL listed for direct burial in earth and concrete

NAED NUMBER	CATALOG NUMBER	GROUND ROD SIZE (IN)	GROUND WIRE MAX	CTN QTY	EST. SHIPPING	
					WEIGHT (lbs)	UNIT
27000	G 29	3/8	#4 STR	50	3.3	CTN
27010	G 30	1/2	#4 SOL	50	4.2	CTN
27020	G 31	5/8	1/0 SOL	50	5.6	CTN
27030	G 32	3/4	#2 SOL	50	6.7	CTN
27040	G 100	1	4/0 STR	25	7.6	CTN



## PIPE CLAMPS

For connecting ground wire to water pipe  
Cast bronze body, silicon bronze or stainless steel screws  
UL listed for direct burial in earth and concrete

NAED NUMBER	CATALOG NUMBER	WATER PIPE SIZE (IPS)	GROUND WIRE MAX	CTN QTY	EST. SHIPPING	
					WEIGHT (lbs)	UNIT
70620	G 1S-DB	1/2 - 1	#2 STR	50	9.5	CTN
70622	G 2S-DB	1 1/4 - 2	#2 STR	25	9.0	CTN



**Direct Burial**



## U-BOLT CLAMPS

Heavy Duty U-bolt Clamps  
Use to connect wire to pipe, rod, or fence posts  
Cast bronze bodies with silicon bronze hardware  
CSA Certified for direct burial in earth and concrete

NAED NUMBER	CATALOG NUMBER	ROD SIZE (IN)	WATER PIPE SIZE (IPS)	CABLE RANGE	EST. SHIPPING	
					WEIGHT (lbs)	UNIT
25020	C 101	1/2	1/4		0.5	EA
25080	C 104	5/8 - 3/4	3/8	2/0 - #4	0.6	EA
25160	C 108	7/8 - 1	1/2 - 3/4		0.6	EA
25260	C 114	-	1		0.7	EA
25360	C 120	-	1 1/4	2/0 - #4	0.9	EA
25560	C 132	-	2		1.0	EA
71245	C 142	-	3		1.5	EA

See C100 Series for complete listing of sizes.  
PLATING: For tin plating of above items add suffix "P" to catalog number.

**Direct Burial**

Continuous Loop

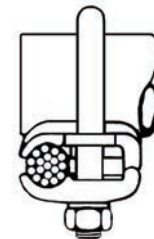

Parallel or 90° connection to rod or pipe

## STAINLESS STEEL HARDWARE KITS

Sets of stainless steel screws, washers, and nuts  
Use to mount BTL-DB and BL Series lugs to equipment  
Each kit packaged in clear plastic display box

NAED NUMBER	CATALOG NUMBER	SCREW		KIT CONTENTS				EST. SHIPPING	
		SIZE	L (IN)	SCREWS	WASHERS FLAT	NUTS LOCK	WEIGHT (lbs)	UNIT	
27221	SS 10-A	10-24	1/2	50	100	50	50	.4	KIT
27223	SS 10-B		3/4					.5	KIT
27225	SS 10-C		1					.6	KIT
27226	SS 10-D		1 1/4					.6	KIT
27231	SS 0-A	1/4-20	1/2	25	50	25	25	.6	KIT
27233	SS 0-B		3/4					.7	KIT
27235	SS 0-C		1					.8	KIT
27237	SS 0-D		1 1/2					.9	KIT

For larger sizes of stainless steel or silicon bronze see hardware section.

**Direct Burial**

