



SPLICES

High conductivity copper
Tin plated



B SERIES

Butt Splices

NAED NUMBER	CATALOG NUMBER	WIRE RANGE	COLOR	L	QTY/BOX	EST. SHIPPING	
						WEIGHT (lbs)	UNIT
70000	B 18	#18-22	-	.57	100	0.19	BOX
70001	B 14	#14-16	-	.57	100	0.23	BOX
70002	B 10	#10-12	-	.57	50	0.21	BOX
70004	* B 10S	#10-12	-	.82	50	0.27	BOX
70003	* B 8	#8	-	.82	25	0.24	BOX
70010	B 18V	#18-22	RED	.95	100	0.25	BOX
70011	B 14V	#14-16	BLUE	1.02	100	0.31	BOX
70012	B 10V	#10-12	YELLOW	1.01	50	0.27	BOX
70013	* B 8V	#8	RED	1.46	25	0.27	BOX
70020	B 18N	#18-22	RED	1.01	100	0.32	BOX
70021	B 14N	#14-16	BLUE	1.02	100	0.33	BOX
70022	B 10N	#10-12	YELLOW	1.01	50	0.32	BOX

* Seamless

Non-Insulated
Butted Seam

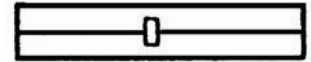

Vinyl Insulated
Butted Seam

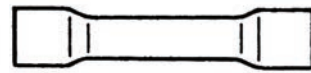

Nylon Insulated
Seamless

Reducing butt splices for copper wires
Available bare and vinyl insulated

B-R SERIES

Reducing Butt Splices

NAED NUMBER	CATALOG NUMBER	WIRE RANGE		COLOR	QTY/BOX	EST. SHIPPING	
		SIDE A	SIDE B			WEIGHT (lbs)	UNIT
54010	B 14R18	#16-14	#22-18	BLUE W/RED STRIPE	100	0.23	BOX
54020	B 10R14	#12-10	#16-14	YELLOW W/BLUE STRIPE	50	0.21	BOX
54030	B 8R10	#8	#12-10	RED W/YELLOW STRIPE	50	0.27	BOX
54040	B 6R8	#6	#8	BLUE W/RED STRIPE	25	0.24	BOX
70040	B 10R14V	#12-10	#16-14	YELLOW W/BLUE STRIPE	100	0.31	BOX
70041	B 14R18V	#16-14	#22-18	BLUE W/RED STRIPE	100	0.25	BOX
70042	B 6R8V	#6	#8	BLUE W/RED STRIPE	25	0.27	BOX
70043	B 8R10V	#8	#12-10	RED W/YELLOW STRIPE	50	0.27	BOX

B-R series not UL listed.



Non-Insulated



Vinyl Insulated



C-N SERIES

Nylon Pigtails

NAED NUMBER	CATALOG NUMBER	WIRE RANGE	COLOR	L	QTY/BOX	EST. SHIPPING	
						WEIGHT (lbs)	UNIT
70031	C 14N	#14-16	Clear	.69	100	0.14	BOX
70032	C 10N	#10-12	Clear	.73	50	0.15	BOX

Closed
End Connectors

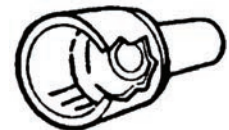

SP SERIES

Snap Plugs – Male

NAED NUMBER	CATALOG NUMBER	WIRE RANGE	COLOR	L	QTY/BOX	EST. SHIPPING	
						WEIGHT (lbs)	UNIT
70050	SP 14	#14-16	-	.58	50	0.12	BOX
70051	SP 14V	#14-16	BLUE	.84	50	0.15	BOX

Vinyl Insulated
Butted Seam



Nylon Insulated
Seamless

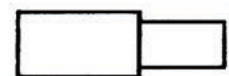

Snap Plugs – Female

70061	FSP 156N	#14-16	BLUE	1.025	50	0.15	BOX
-------	-----------------	--------	------	-------	----	------	-----